



Main Specifications

Item		FE30A
Max. workpiece diameter	mm in	φ310 12.2
Max. module		8
Max. workpiece width	mm in	150 5.9 (Maximum stroke 150 5.9)
Machining method		Conventional, Diagonal, Under path, Flange
Max. cutter width	mm in	50.8 2.0
Cutter bore diameter	mm·min ⁻¹ ipm	63.5 2.5
Cutter speed	min ⁻¹	65~500
Max. workpiece speed	min ⁻¹	3,000
Cutter head travel	mm in	160 6.3 (Center distance between work/cutter 105-265 14.1-10.4)
Cutter head forward/backward travel	mm in	± 30 ±1.2
Cutter swivel angle	°	± 20
Cutter spindle diameter	mm in	90 3.5
Cutter drive motor	kW HP	7.5 10
Software		Conversational programming
No. of NC axes		4
NC system		FANUC Series 32i-B
Total power consumption	kVA	20 (std.)
Machine weight	kg lb	7,500 16,540

Standard Equipment

- Hydraulic and lubrication oil system
 - Flood coolant supply system (excluding coolant separator)
 - Coolant splash guard, tall type
 - Electronic door interlock system
 - NC System : 3-axis model
 - 4-axis model
 - Infinitely controlled cutter axis
 - Automatic dimensioning control
 - Work light/Machine status light
 - Light in the control box/Lamp check circuit
 - Power saving circuit/Work counter/Power outlet
 - NC device, FANUC Series 32i-B with memory card
- Cutter power clamp
 - Cutter support
 - Cutter head automatic clamping
 - Two hand operation/Circuit breaker with ground fault/Spindle load meter
 - Maintenance tool kit
 - Table and fixture flushing unit
 - Coolant gun
 - Compliant with safety standards (category 3)
 - Origin nameplate/machine installation ▼ mark/ various displays

Optional Equipment

- Fixture
 - Coolant separator
 - Automatic gear meshing device
 - Various types of automatic loader
 - Automatic operating coolant splash guard
 - Transfer device/Part stacker
- Part rest
 - Auxiliary control panel
 - Additional memory
 - Traveling headstock
 - Custom made center
 - Rough locator

Machine Dimensions

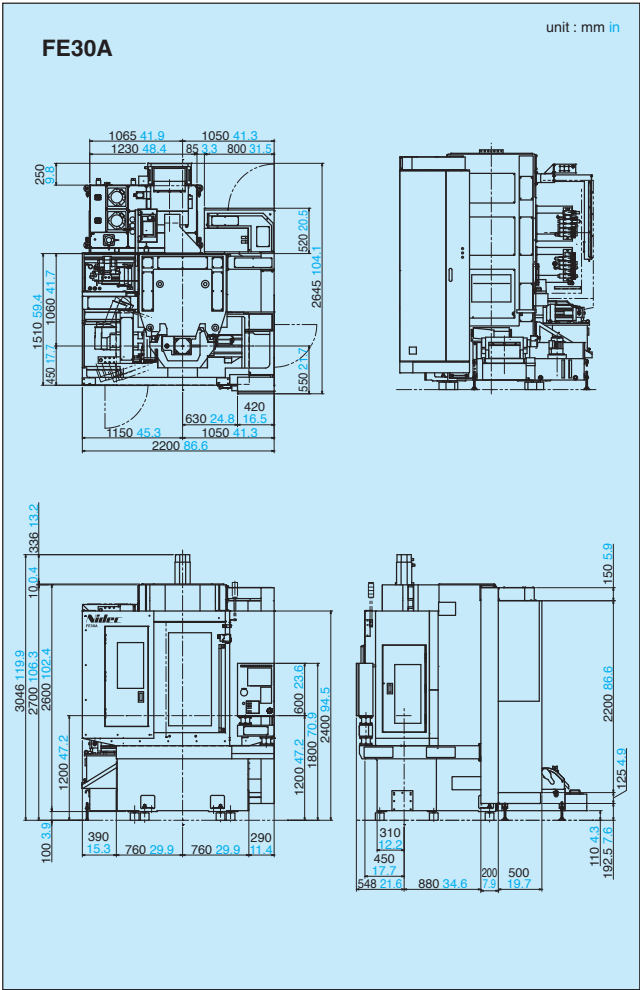

Inquiry

NIDEC MACHINE TOOL CORPORATION

Customer Support & Sales Headquarters 130, Rokujizo, Ritto, Shiga, 520-3080, Japan

www.nidec.com/en/nidec-machinetool/



Global Group	Gear Manufacturing System Group	Total Solution Group	Micro Machining Solution Group
Phone: 81-77-552-9768 Facsimile: 81-77-552-9774	Phone: 81-77-552-9760 Facsimile: 81-77-553-1404	Phone: 81-77-501-3822 Facsimile: 81-77-554-3193	Phone: 81-77-501-3822 Facsimile: 81-77-554-3193

MITSUBISHI HEAVY INDUSTRIES (SHANGHAI) CO., LTD. (MHISH) Machine Tool Group 22nd floor, Office Tower 1, Raffles City Changning, No.1133 Changning Road, Changning District, Shanghai, 200051 China Phone: 86-21-6841-3030 Facsimile: 86-21-6841-5222 URL: www.mhi.com.cn/	MITSUBISHI HEAVY INDUSTRIES, LTD. Jakarta Liaison Office 12th Floor, Sentral Senayan II Jl. Asia Afrika No.8, Gelora Bung Karno, Senayan Jakarta 10270, Indonesia Phone: 62-21-57974430 Facsimile: 62-21-57974435	MITSUBISHI HEAVY INDUSTRIES AMERICA, INC. (MHIA) Machine Tool Division 46992 Liberty Drive, Wixom, MI 48393 U.S.A. Phone: 1-248-669-6136 Facsimile: 1-248-669-0614 URL: mitsubishimachinetools.com
MITSUBISHI HEAVY INDUSTRIES MACHINE TOOL CO., LTD. Taipei Branch 6F-1., No.100, Songren Rd., Xinyi Dist., Taipei City 11073, Taiwan Phone: 886-2-2720-3310 Facsimile: 886-2-2720-5236	MH POWER SYSTEMS KOREA, LTD. 20F, D1, D-Tower, 17, Jong-ro 3-gil, Jongno-gu, Seoul, 03155, Korea Phone: 82-2-2187-0200 Facsimile: 82-2-2187-028	MITSUBISHI HEAVY INDUSTRIES MEXICANA, S.A. DE CV. Queretaro Branch Francisco I. Madero #221, Int. 14, Piso 2. Centro, Santiago de Queretaro, Qro. CP. 76000 Phone: 52-442-242-33-51, 52-442-242-16-85
MITSUBISHI HEAVY INDUSTRIES INDIA PRIVATE LTD. (MHII) Machine Tool #402, 4th Floor, Worldmark-2, Aerocity NH-8, Delhi-110037 India Phone: 91-11-4102-1234 Facsimile: 91-11-4102-5150 URL: www.mhiindia.com/	MITSUBISHI HEAVY INDUSTRIES (THAILAND) LTD. (MHIT) Machine Tool Business Unit 173/31, 173/34 Asia Center Building 25th Floor, South Sathorn Road, Thungmahamek, Sathorn, Bangkok 10120, Thailand Phone: 66-2679-0600 Facsimile: 66-2679-0601 URL: www.mhit.co.th/	MITSUBISHI INDUSTRIAS PESADAS DO BRASIL LTDA. Rua Pamplona, 145-10 andar, Conj 1001, Praca Pamplona CEP 01405-900, Jardim Paulista, Sao Paulo, SP, Brazil Phone: 55-11-3170-9205
	MITSUBISHI HEAVY INDUSTRIES EUROPE, LTD. (MHIE) Munich Branch Sonnen str. 32 6F, 80331 Munich, Germany Phone: 49-89-211079-0 Facsimile: 49-89-211079-33 URL: www.mhie.com	

Machine specifications such as dimensions etc., are fixed using SI units including the metric system.
Data shown in other units in blue, such as inches, pounds and gallons etc. are for reference only and the formal data in black supercede any equivalent data given in blue when fractions caused by conversion become an issue.
Specifications are subject to change without prior notice.
The export of this product is subject to Japanese Governmental approval.

Printed in Japan



GEAR SHAVING MACHINE

FE30A



NIDEC MACHINE TOOL CORPORATION

www.nidec.com/en/nidec-machinetool/



GEAR SHAVING MACHINE FE30A

We Bring to You the Most Advanced Gear Shaver, F-Series, Packed with Innovative Features. This Shaving Machine has been designed and built reflecting the needs of the customer.

Line Configuration Oriented Machine

Line configuration made easy by locating the control, hydraulic and coolant equipment to the rear of the machine for easier maintenance.

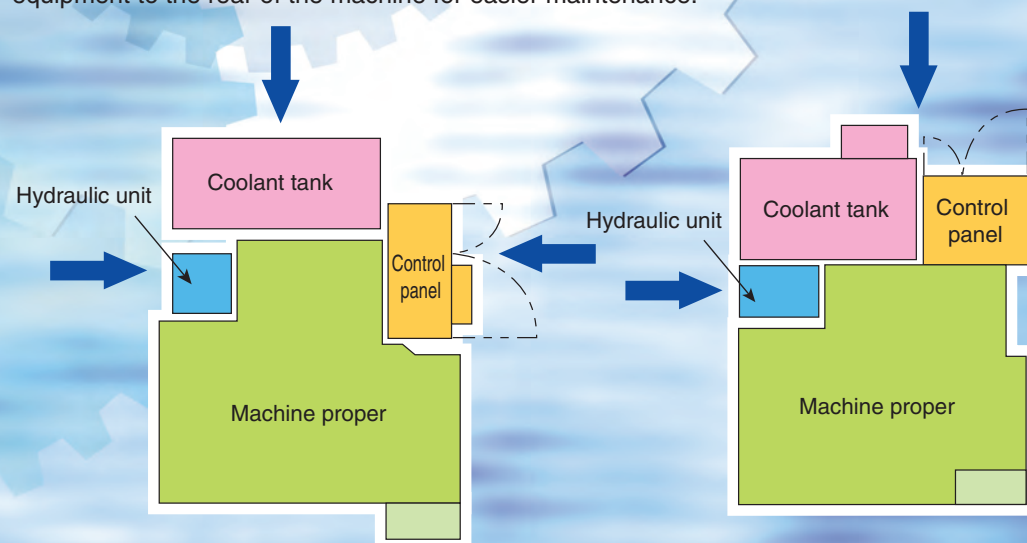

Our conventional machine

Maintenance required from 3 directions

FE30A

Maintenance required from only 2 directions

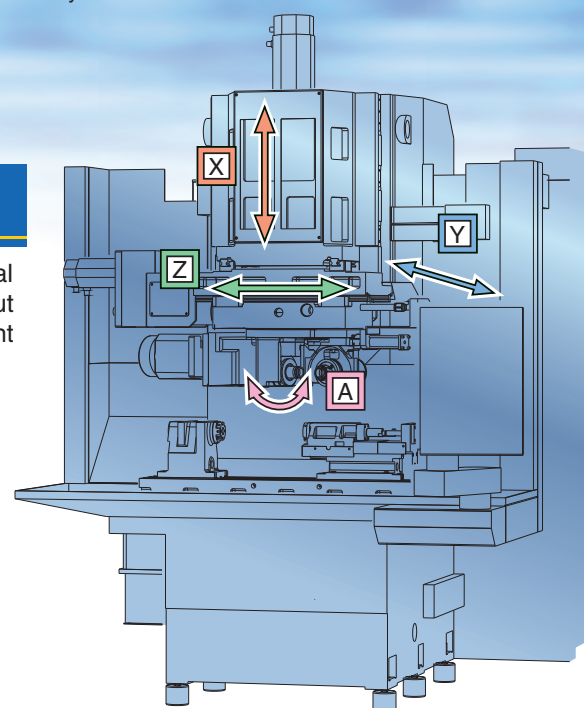

Axes Configuration

Crowning taper shaping can be done with the conventional diagonal (traverse) method with this 4-axis controlled machine by simple input utilizing the graphical display screen. Moreover, taper/lead adjustment for left hand/right hand gears can be done individually by simple numeric input during plunge cutting and under-pass cutting.

No.	Axis	Nomenclature
1	X	Radial feed
2	Y	Cutter head feed (forward/backward)
3	Z	Cutter head feed (left/right)
4	A	Cutter head swivel

Improved Operation Interface, Installed with Newly Developed Software

- Equipped with large 10.4 inch LCD screen
- Simple input programming and HELP functions utilizing the graphical display screen

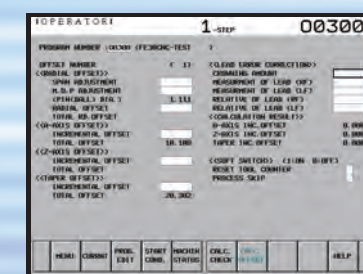

Lead compensation input screen



Multiple-step feed is also possible

Visual Observation of Cutting Conditions

Adjustment of cutting conditions made easy as the cycle diagram and main spindle amperage can be observed visually during actual machining.

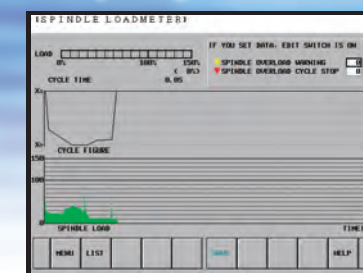

Dual Hinged Swiveling Operator's Control Panel

Improves accessibility to the workpiece.



GEAR SHAVING MACHINE FE30A